

# EOSC EU Node Tools Hub User Guide

Version 1.4 – 14/05/2024

## Table of Contents

<b>1. Search and Favourite Existing Tools .....</b>	<b>2</b>
1.1. All Tools Tab.....	2
1.2. Favourites Tab.....	3
<b>2. Deploy a Tool.....</b>	<b>4</b>
2.1. Deployment Wizard .....	4
2.2. Deployments Tab .....	5
<b>3. Create a Tool .....</b>	<b>6</b>
3.1. Create Tool Wizard (I/III) .....	6
3.2. Create Tool Wizard (II/III) .....	7
3.3. Create Tool Wizard (III/III) .....	8
3.4. The <b>My Tools</b> Tab .....	9

# 1. Search and Favourite Existing Tools

## 1.1. All Tools Tab

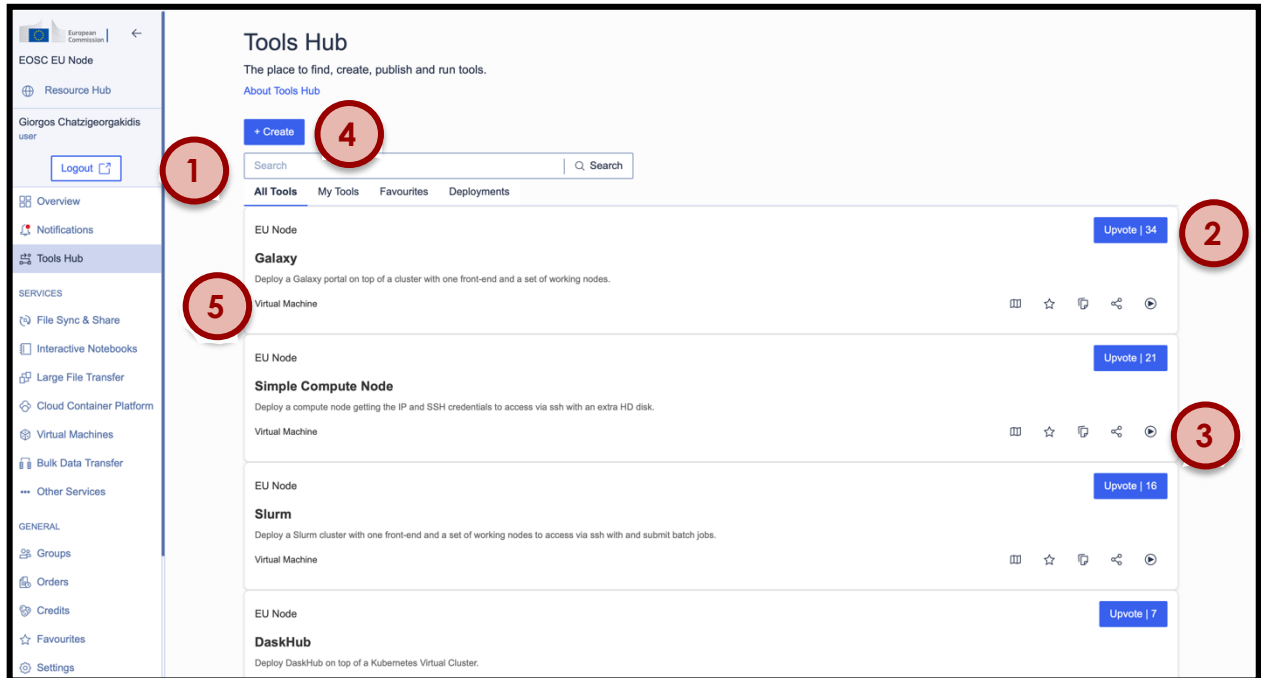

- While in the **All Tools** tab, you may search for a specific tool by entering a keyword to the search box. All tools published by either EOSC EU Node or other users appear here - (1)
- You may upvote a tool of your preference by clicking on the **Upvote** button. The number of upvotes for all published tools is available to all users - (2)
- For each tool in the list, you may click one of the action icons to view its details, add it to your **Favourites** (Section 1.2), deploy it (Sections 2.1 and 2.2), or copy it to **My Tools** (Section 3.4) - (3)
- To create a new tool, you may click on the **Create** button (Sections 3.1, 3.2 and 3.3) - (4)
- Make sure to have allocated resources for the appropriate service required by a tool before deploying it - (5)

## 1.2. Favourites Tab

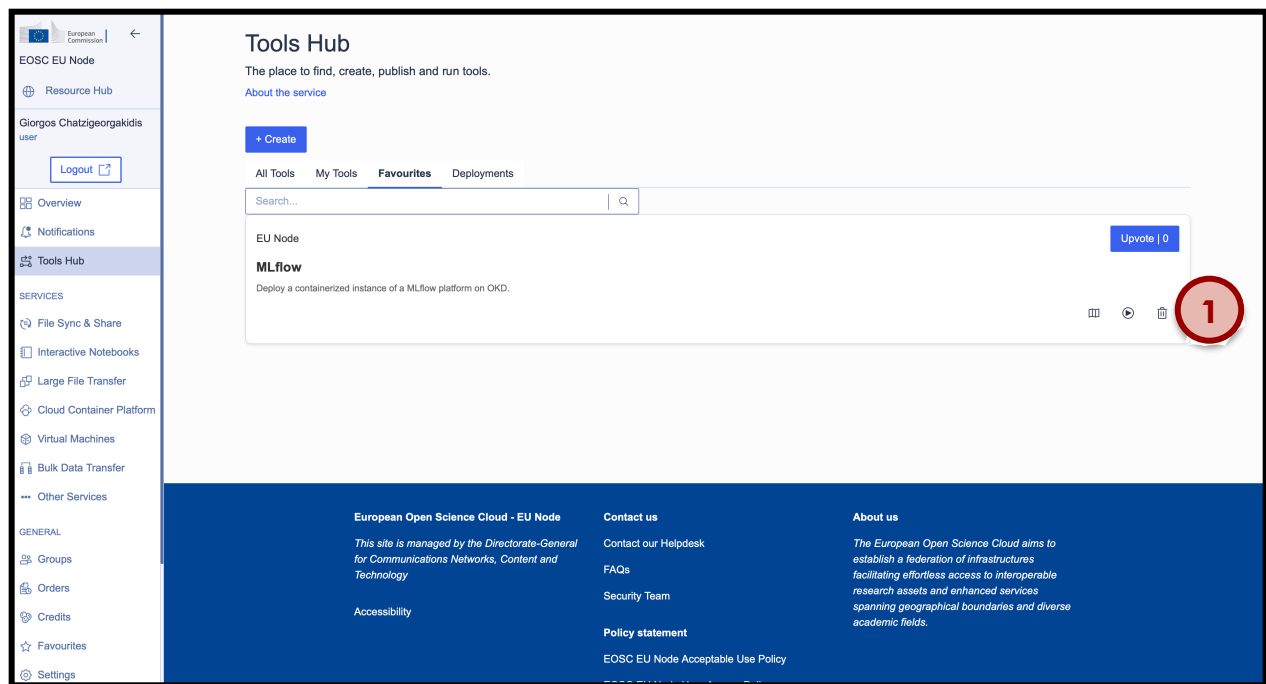

- Your **Favourites** tab contains all the tools you have added as favourites
- You may either view the details, deploy, or delete each favourited tool - (1)

## 2. Deploy a Tool

### 2.1. Deployment Wizard

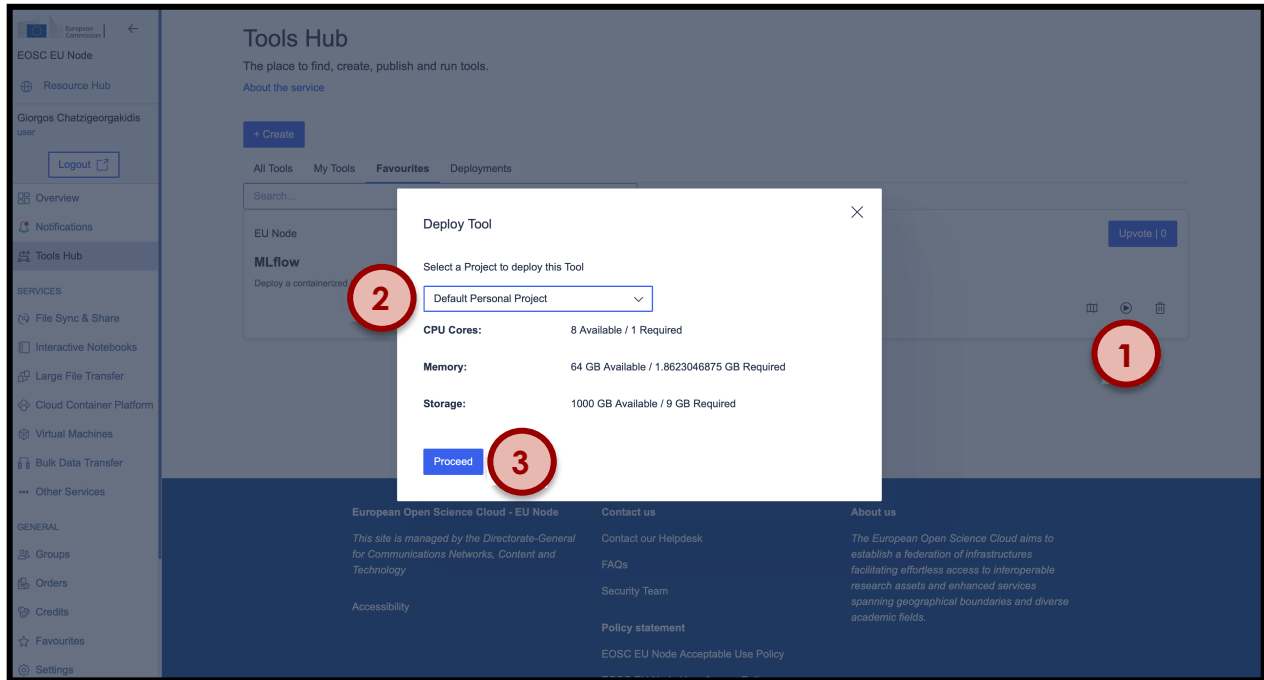

- Before deploying a tool, make sure that you have allocated the necessary resources to your personal or group project. In this example, a Cloud Container Platform Deployment is needed beforehand
- To deploy a tool, click on the **Deploy** button - (1)
- On the dialog that appears, select an available **Personal** or **Group** project to deploy the tool - (2)
- If the resources are sufficient, proceed with deploying the tool. When your tool is deployed, you will receive a notification - (3)

## 2.2. Deployments Tab

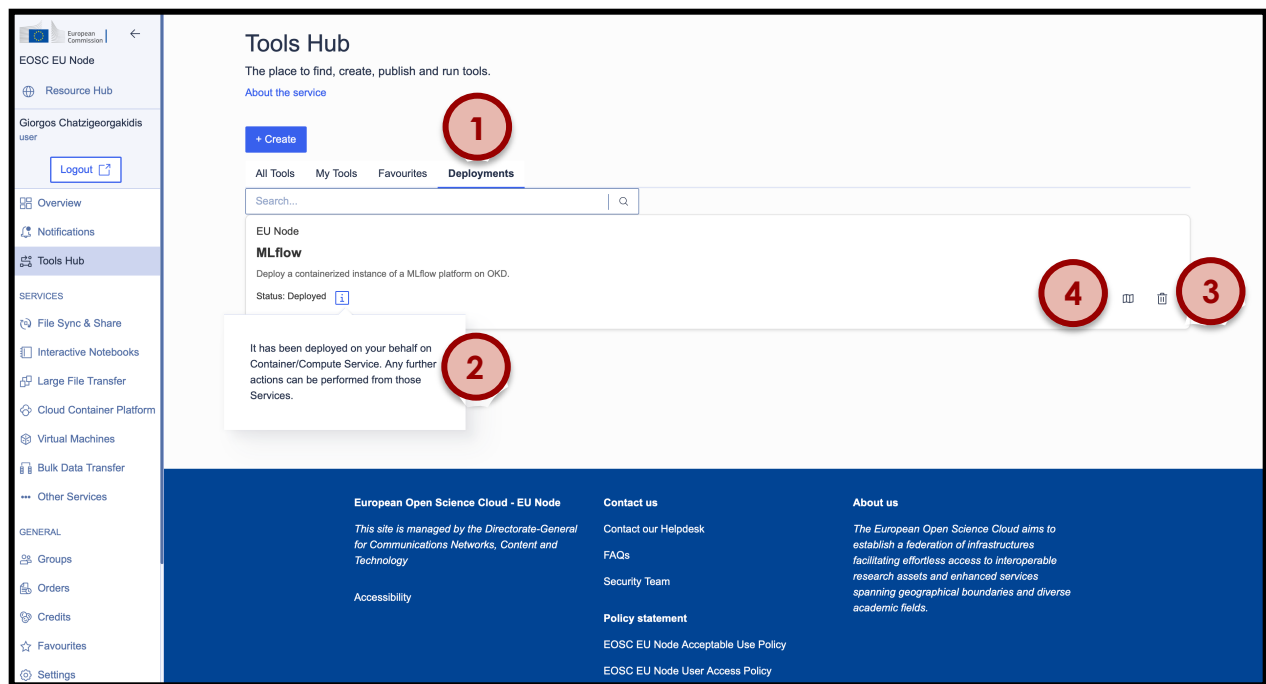

- Upon successful deployment your tool will be available under the **Deployments** tab - (1)
- The **Tools Hub** deploys your tool on your behalf on the appropriate service on which you had already allocated resources. As indicated in the pop-up message, you may now access your deployed tool by visiting the corresponding service page (please refer to the corresponding user guide and documentation for further instructions) - (2)
- You may stop your tool at any time by clicking on the **Remove** button - (3)
- Once your tool is deployed you may click on the **Show Details** button to get the required information to access your tool. For example, if your tool creates a Virtual Machine, you will be provided with the assigned IP, username and SSH private key needed to access it. You may copy the value of the token field into a file as follows: `echo -e "<<your_key>>" > ssh_key.pem && chmod 600 ssh_key.pem`. Then, you may access your created VM by issuing: `ssh -i ssh_key.pem username@vmip` - (4)

## 3. Create a Tool

### 3.1. Create Tool Wizard (I/III)

The screenshot shows the 'Tool Details' wizard interface. On the left is a sidebar with the 'EOSC EU Node' logo, a 'Resource Hub' link, the user 'Giorgos Chatzigeorgakidis', a 'Logout' button, and a list of services and general settings. The main area is titled 'Tool Details' and contains a progress indicator showing three steps: 'Metadata' (selected and marked with a red circle with the number 1), 'Content', and 'Review'. Below the progress indicator is a progress bar showing '1/2 required steps complete' and '65%'. The 'Metadata' step includes several form fields: 'Name' (with a red asterisk), 'Description' (with a red asterisk), 'Resource Organisation' (with a red asterisk), 'License' (a dropdown menu), 'Version Date', and 'Keywords' (with a red asterisk). Each field has a 'Suggested length' note. The 'Name' field contains 'Test Tool', 'Description' contains 'This is a test tool.', 'Resource Organisation' contains 'Athena R.C.', 'License' is set to 'Apache License 2.0', 'Version Date' is 'Mon Nov 11 2024', and 'Keywords' is empty. At the bottom of the main area are 'Cancel and Exit' and 'Next >' buttons.

- To create your tool, you must complete all the steps of the wizard
- At the **Metadata** step, you must provide all necessary metadata for your new tool, such as name, description and license - (1)

## 3.2. Create Tool Wizard (II/III)

**Tool Details**

Fields with (\*) are mandatory for submission. Blank optional fields won't appear on the published page.

Metadata \* ✓

Content \* **1** ✓

3 Review

**TOSCA File**

Upload an existing file **2** **Replace file**

Edit the uploaded file or create a new one **3**

```
1 tosca_definitions_version: tosca_simple_yaml_1_0
2
3 - imports:
4   - grycap_custom_types: https://raw.githubusercontent.com/grycap/tosca/main/custom_types.yaml
5
6 - description: >
7   Deploy a compute node getting the IP and SSH credentials to access via ssh with an extra HD disk.
8
9 - metadata:
10  template_name: VM
11  template_version: "1.1.0"
12  template_author: Miguel Caballer
13  creation_date: 2020-09-08
14  display_name: Deploy a VM
15  icon: images/vm-icon-disk.png
16  tag: VM
17  order: 1
18  tabs:
19    - VM Data:
20      - mem_cpus
21      - mem_size
22      - disk_size
```

2/2 required steps complete 100%

Cancel and Exit Previous Next >

- In the **Content** step of the tool creation wizard, you must provide the content of the tool, by uploading a TOSCA template in YAML format. To find out more about TOSCA templates, please visit [this](#) webpage - **(1)**
- To upload an existing TOSCA template, you may on the **Choose file** button. Once the file is uploaded, the button text changes to **Replace file**. You may click on it to upload a different TOSCA template - **(2)**
- In the provided editor, you may either change the code of the TOSCA template file you have uploaded, or create your own TOSCA template from scratch - **(3)**

### 3.3. Create Tool Wizard (III/III)

European Commission

EOSC EU Node

Resource Hub

Giorgos Chatzigeorgakidis user

Logout

Overview

Notifications

Tools Hub

SERVICES

File Sync & Share

Interactive Notebooks

Large File Transfer

Cloud Container Platform

Virtual Machines

Bulk Data Transfer

Other Services

GENERAL

Groups

Orders

Credits

Favourites

Settings

**Tool Details**

Fields with (\*) are mandatory for submission. Blank optional fields won't appear on the published page.

Metadata \*

Content \*

Review

2/2 required steps complete 100%

Cancel and Exit

**Metadata**

Name: Test Tool

Description: This is a test tool.

Resource Organisation: Athena R.C.

Version Date: Fri Dec 20 2024

Keywords: test

Deprecated: No

Scientific Categorisation:

Scientific Domain: Engineering & Technology

Scientific Subdomain: Electrical, Electronic & Information Engineering

Target Infrastructure: Container Service

License: Apache License 2.0

**Content**

Tosca File:

```
1  tosca_definitions_version: tosca_simple_yaml_1_0
2
3  - imports:
4    - grycap_custom_types: https://raw.githubusercontent.com/grycap/tosca/main/custom_types.yaml
5
6  - description: >
7    Deploy a compute node getting the IP and SSH credentials to access via ssh with an extra HD disk.
8
9  - metadata:
10    template_name: VM
11    template_version: '1.1.0'
12    template_author: Miguel Caballer
13    creation_date: 2020-09-08
14    display_name: Deploy a VM
15    icon: images/vm-icon-disk.png
16    tag: VM
```

Previous Confirm

- In the **Review** step you may review the provided information for your tool and confirm it - (1)
- In case of any mistakes, you may go back to apply corrections by either clicking on the edit links of each section, or on the **Previous** button - (2), (3)
- Finally, to create your tool, you must click on the **Confirm** button - (4)
- Your new tool will be listed under **My Tools** (Section 3.4)



### 3.4. The My Tools Tab

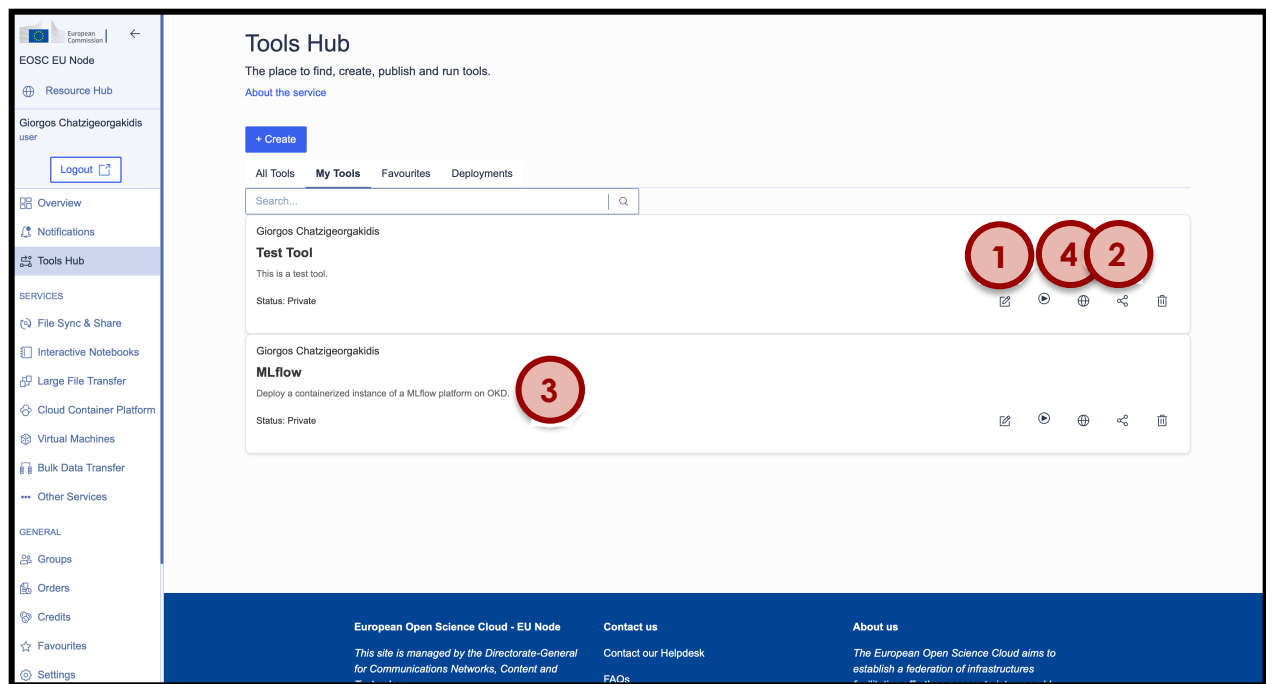

- Any tool you have created via the tool creation wizard will be listed in the **My Tools** tab. Here, you have some additional options
- You may edit the metadata and/or provided TOSCA template of your tool by clicking on the **Edit** button - (1)
- You may share the tool with another user. Clicking on the **Share** button generates a link, which can be shared to another person. Of course, they must also be users of EOOSC EU Node to access the tool - (2)
- Another way to add tools in your **My Tools** tab is by clicking on the **Copy to My Tools** button of a published tool at the **All Tools** tab (Section 1.1). The tools creation wizard opens again for you to optionally edit any of its metadata and/or TOSCA template file - (3)
- Finally, you may request to publish your tool by clicking on the **Publish** button. Before being published, your tool must first be approved by the Back-Office of EOOSC EU Node. Once your tool is approved you will receive a notification. Publishing your tools makes it available in the **All Tools** tab for other users to also access and use - (4)